

Space

SLC1510 SLC1515
SLC1513 SLC1516
SLC1514 SLC1517

SLC
Scandinavian
Lighting Concept

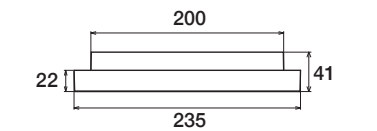
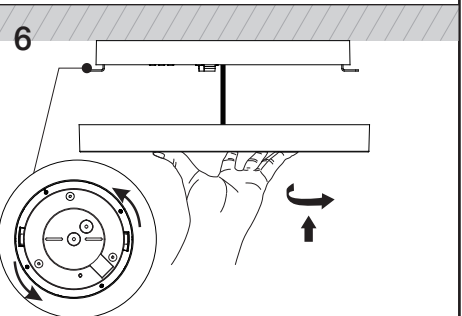
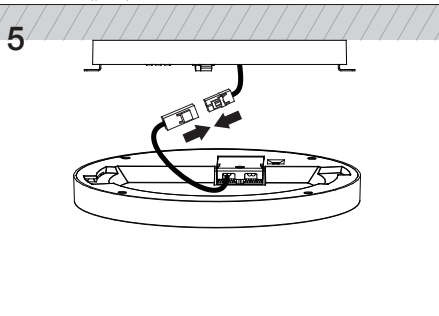
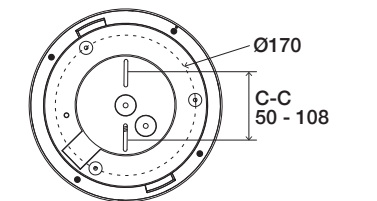
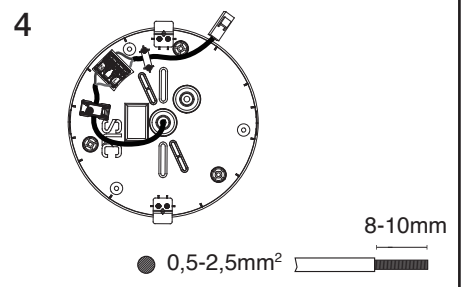
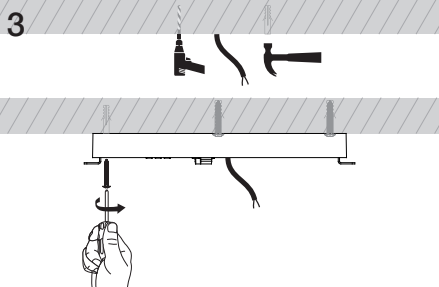
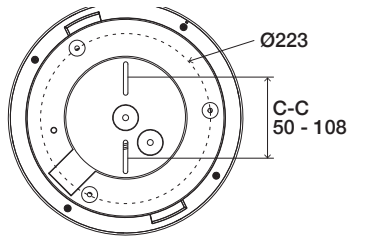
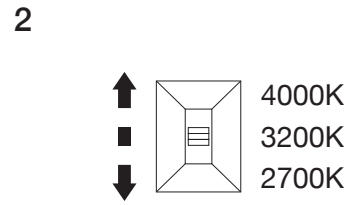
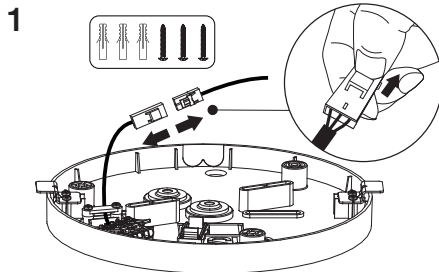
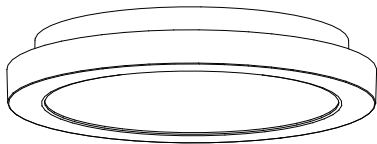

For surface mounting cabling

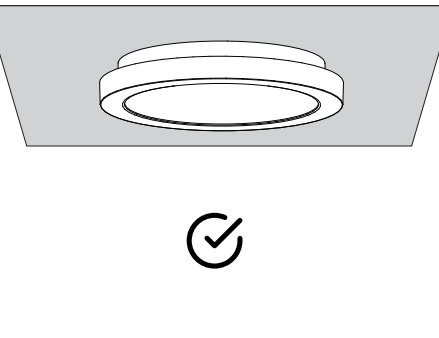
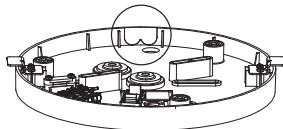

Sensor →



NO: Må installeres av godkjent installatør
EN: Only to be installed by an authorized electrician
DE: Nur von einer autorisierten Elektrofachkraft installieren lassen
FI: Asenna vain valtuutettu sähköasentaja
FR: Seulement pour être installé par un électricien autorisé
IS: Aðeins skal setja upp af viðurkenndum rafvirkni
ES: Solo para ser instalado por un electricista autorizado.
IT: Solo per essere installato da un elettricista autorizzato



NO: Slå av strømmen før montering
EN: Power off before installing
DE: Schalten Sie vor der Installation die Stromversorgung aus
FI: Katkaise virta ennen asennusta
FR: Couper le courant avant d'installer
IS: Slökktu á orku áður en þú setur upp
ES: Apague la alimentación antes de instalar
IT: Spegnerne l'alimentazione prima di installare

Space

SLC1510 SLC1515
SLC1513 SLC1516
SLC1514 SLC1517

SLC
Scandinavian
Lighting Concept

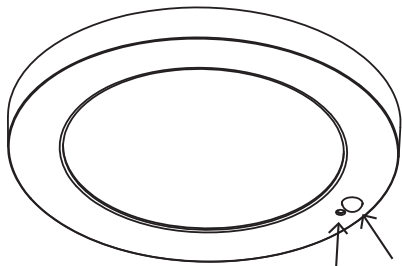

PIR Sensor



Set the preferred colour temperature and luminous flux

4000K	↑	22W	↑
3200K	↓	20W	↓
2700K	↓	16W	↓

	ON	OFF						
STANDBY LIGHT	5m	∞	∞ (Never turns off)					
	10%	0	0					
DAYLIGHT SENSOR	☀	☾	☾	☾	☾	☾	☾	☾
HOLD TIME		5s	1m	3m	10m			
		5s	1m	3m	10m			
		5s	1m	3m	10m			
		5s	1m	3m	10m			
DETECTION AREA	50%	100%						
	50%	100%						

Function	Levels	Description
Stand-by - period	∞ (=unlimited) 5 min	The time the luminaire stays at the stand-by dim level before it is shut off completely.
Stand-by - light	0% (=disabled) 10%	The light level when no movement is detected.
Daylight sensor	ON(30 lux) O (OFF)	When set to ON, and the light level is above 30 lux at the daylight sensor, the light will not turn on even when detecting movement With stand-by light activated, the daylight sensor is disabled
Hold time	5 sec 1 min 3 min 10 min	The time the light is on full light after detecting movement
Detection area	50% 100%	Limits the range/width of detection

Functions

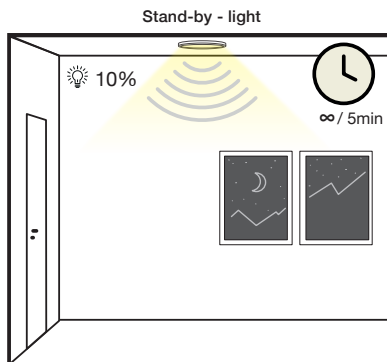
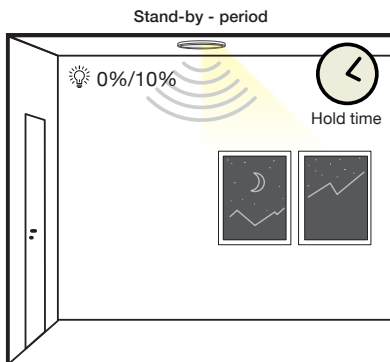
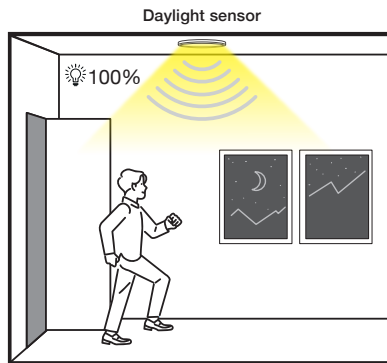
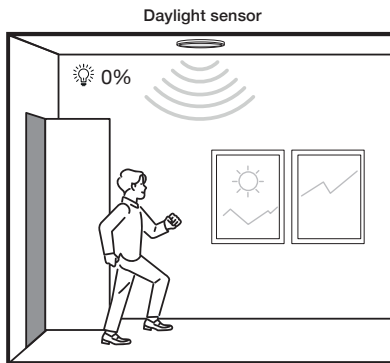

Test

In all cases, when connecting power, the light stays on at full power for about 40 seconds.

With Standby-light

Soft start – about 4 seconds
Soft stop – about 4 seconds

Without Standby-light

Immediate start
Soft stop – about 4 seconds

Sensor ON/OFF function

After the power being on for 40 seconds, turn OFF-ON-OFF-ON in 2 seconds. The light will flash once and the sensor function will be turned off. Light will be constantly on. When turned off more than 2 seconds, it will return to normal sensor operation.

Example: 3-steps

100% in 3min + 10% 5min then off

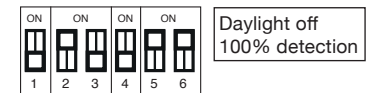

Example: 2-steps

100% in 3min then 10% (Never turns off)

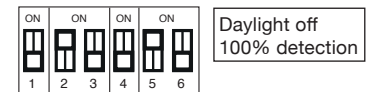

Detection area at 100%

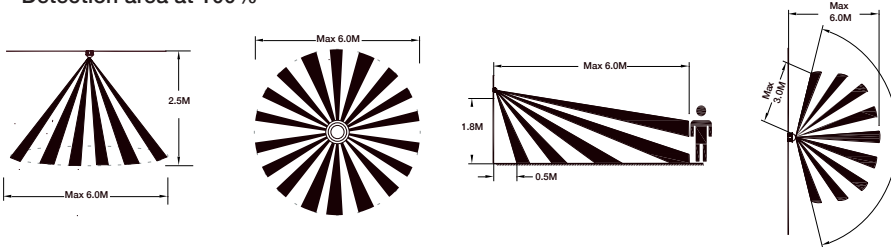

Scan for more information on sensor lighting

